

Installation

S17474 - IP65 - 15W LED CCT Adjustable Microwave Polo Bulkhead

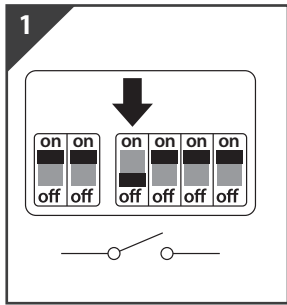

Switch OFF at mains supply before installing

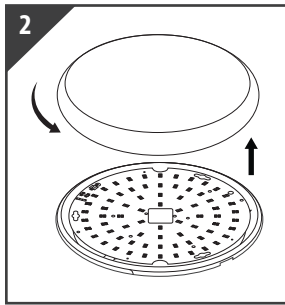

Hold the base securely and twist to unlock and remove the diffuser

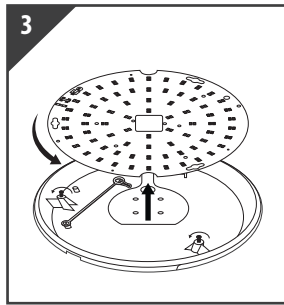

Loosen screws and twist to remove gear tray from the base, detach safety belt

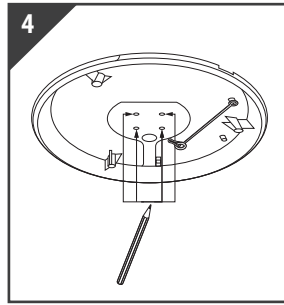

Ensure product is located in the correct location and mark surface

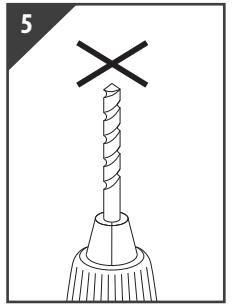

Use correct drill bit to drill screw holes

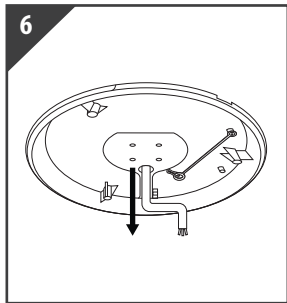

Pull power supply through hole in the base plate

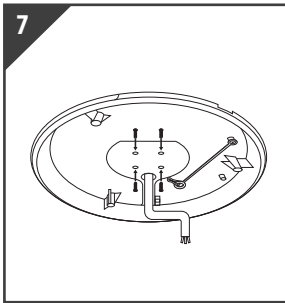

Install the fixing screws to the base plate

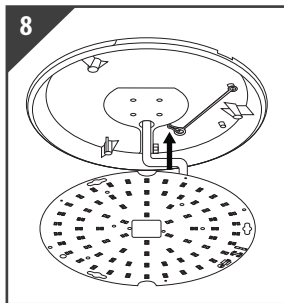

Attach safety belt to gear tray

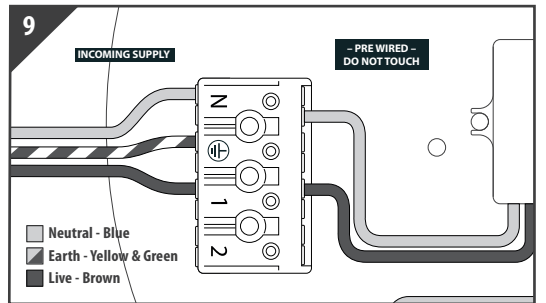

Press the individual terminal and insert the correct incoming supply before releasing the terminal to secure. The product MUST be earthed

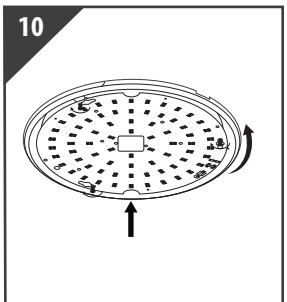

Align gear tray with screws and tighten

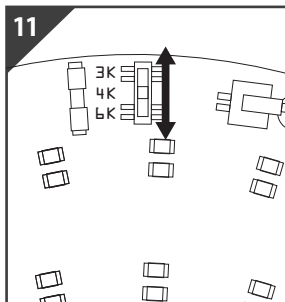

Use the CCT selection switch on the gear tray to select the desired colour temperature

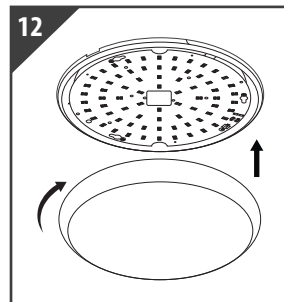

Push and twist the diffuser back into place

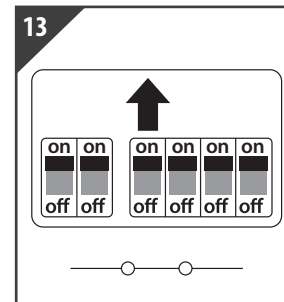

Return power. Switch ON at mains supply

Packaging Information

	SIZE(CM)	N.W/pc (KGS)	G.W.(KGS)	Q'TY(PCS)
Carton	69*66*36.5	1.1	15.2	12

	CTNS	Q'TY(PCS)	VOLUME(CBM)
20" standard container	150	1800	28
40" standard container	320	3840	58

